



MotionSense



MotionSense Pet friendly sensor

Part of 

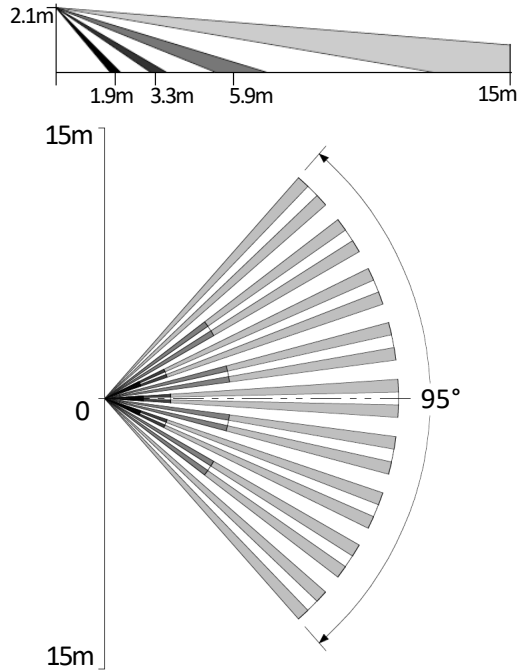

DETECTION COVERAGE



FEATURES

- 15m detection range with 95° angle
- Wireless Xwave² and Xwave² Lite protocols
- Up to 100m line of sight transmission
- Unique and convenient front access for configuring and wiring
- Small pet and rodent immunity (15kg max.)
- Auxiliary input for a wired zone or panic transmission
- Selectable LED indication
- Configurable walk test and pulse counts
- Mountable on flat surfaces or in corner
- Optional swivel bracket for both ceiling or wall mounting

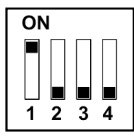
CONFIGURATION

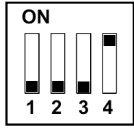
Dipswitches	Description
	ON = AUX PANIC (NO) OFF = AUX ZONE (NC)
	ON = LED ENABLED OFF = LED DISABLED
	ON = 2 PULSE DETECTION OFF = 4 PULSE DETECTION
	ON = WALK TEST OFF = NORMAL

INSTALLATION

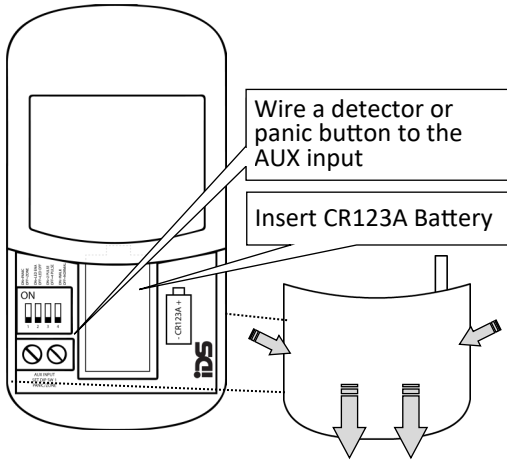

- Remove the bottom cover by pinching and sliding downward.
- Connect wires if using AUX input.
- Set configuration using the dipswitches.
- Insert battery and replace the bottom cover.
- Do a thorough Walk Test after power up.

INSTALLATION TIPS

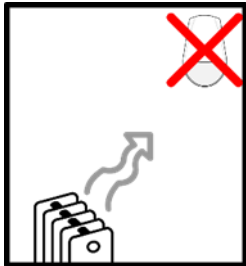

Do not expose to heating or cooling objects.

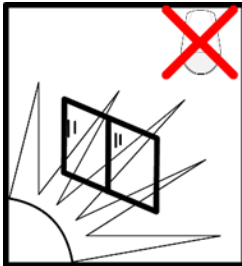

Prevent direct sun light from reaching the PIR.



Do not install behind any object that would block the PIR.

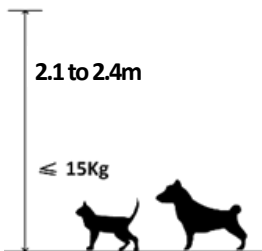

Pets 15Kg and smaller.
Avoid any areas pets can climb.

MOUNTING

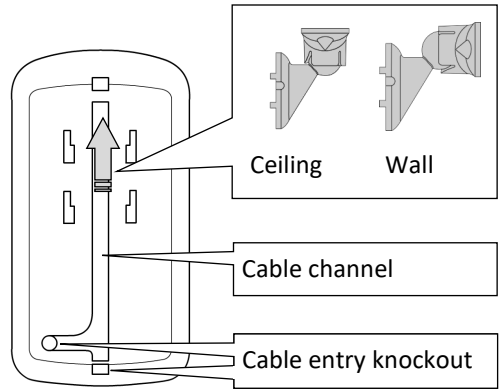

- If using, attach the optional bracket securely to the wall or ceiling and slide the detector onto the brackets vertical slots.
- Feed the AUX input cable into the channel at rear of PIR.
- Knock out the cable entry opening and feed wire through opening and into PIR.

SPECIFICATIONS

Power	CR123A Battery
Battery Life	2 years typical use
Wireless Transmission	869,52 MHz
Transmission Range	100m line of sight
AUX Input	NO/NC trigger
Temp Range	-10°C to +55°C
Pulse Count	2 or 4
Viewing Angle	95°
Mounting Height	2.1m — 2.4m
“Warmup” Period	± 45 seconds
Detection Range	up to 15m



The device was tested using the Huiderei CR123A. Only use the manufacturer approved or equivalent battery. Dispose of batteries in compliance with environmental regulations of your country.