

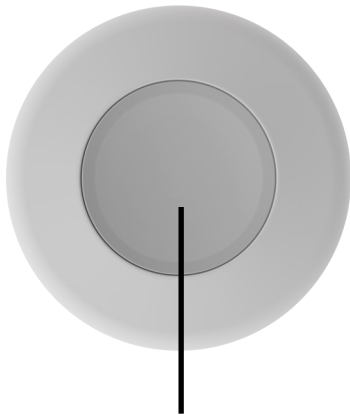

Features

- **Works with the Onyx system**
- **Allows you to Trigger Panics, Fire, Medical, Chime, Relays and Scenarios**
- **Short and long press options**
- **Supports the Xwave² lite protocol**
- **Can be Permanently wall mounted or used as a Pendant.**
- **Status reporting back to the Onyx System.**



Button

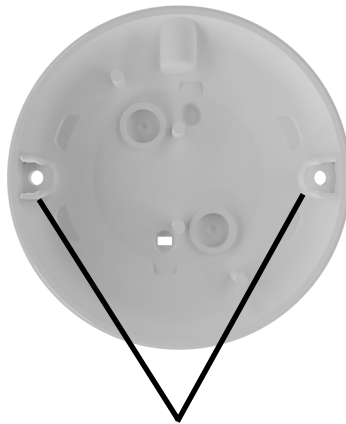

Mounting Holes

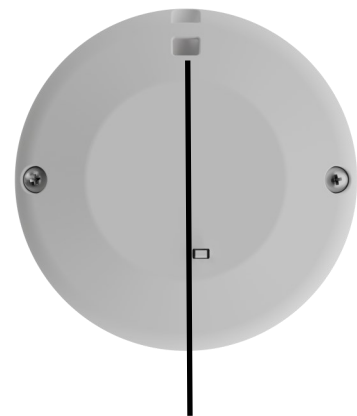

Key-Ring Hook

Installing the Wireless Button

Wall Mounted:

Mount the wireless button securely to the desired location using the mounting holes.

Pendant

Insert Keyring or Lanyard in the key-ring hook.

Learning the Wireless Button

Learn the Wireless Button to the Onyx app by scanning the QR code.

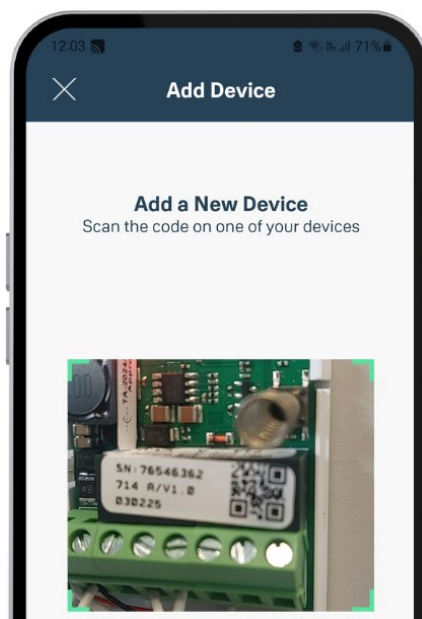

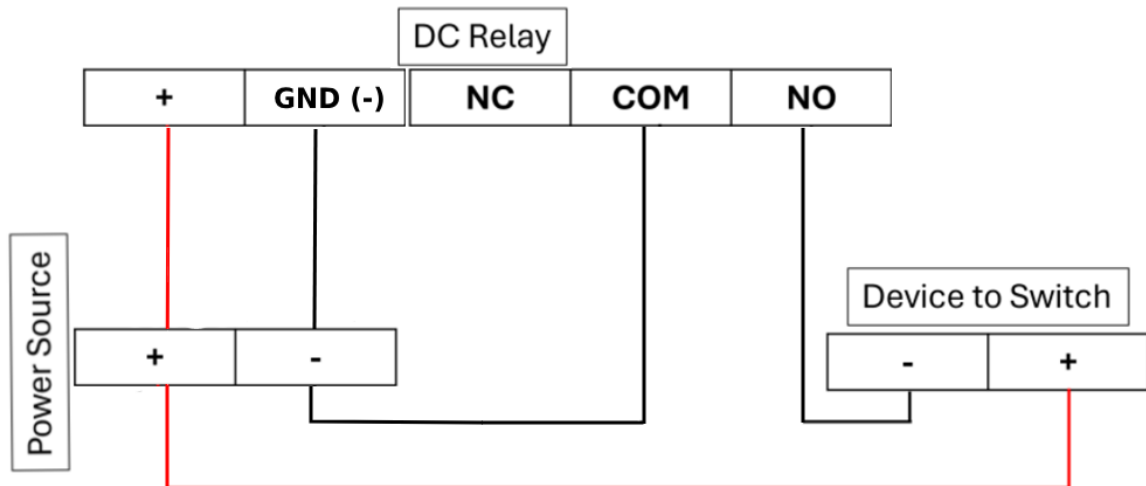

Xwave² DC Relay LEDs

There are two LEDs to indicate the status of the DC Relay:

- **PWR LED:** Will illuminate when there is power to the Wireless DC Relay
- **ACT LED:** Will blink when there is an RF message being sent or received.

Learning the Xwave² DC Relay

Learn the DC Relay to the Onyx app by scanning the QR code.

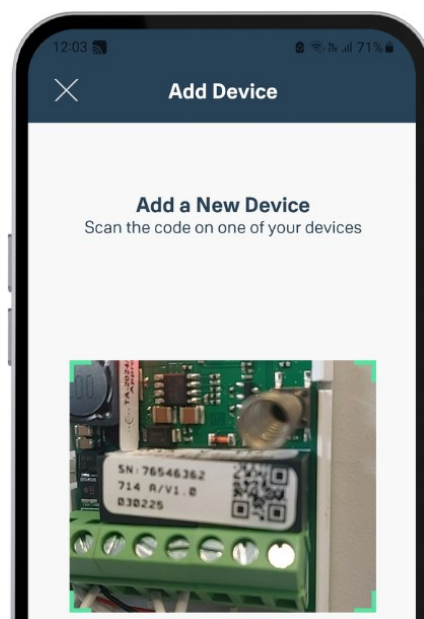

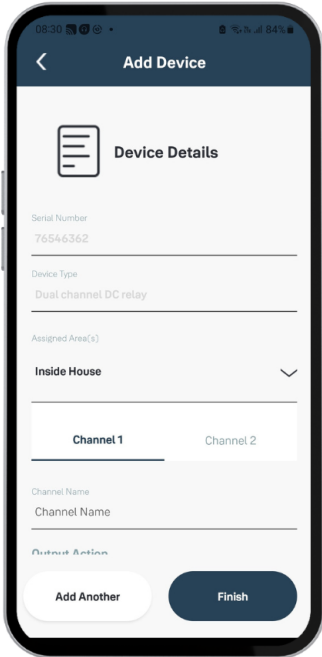

On the device details page, Select the area that the DC relay will belong to.

Give your channel a name and select the output action.

Switch: Gives you the ability to turn a device ON and OFF

Pulse: Gives you the ability to trigger a device. You also need to select the pulse time that you want the device to be triggered for

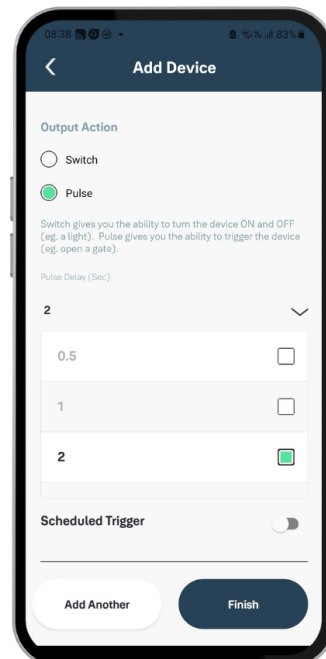
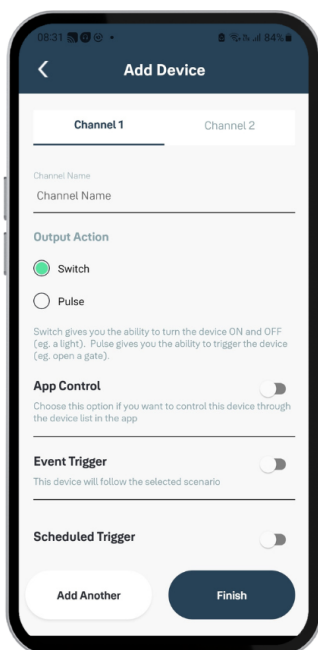

Wireless button

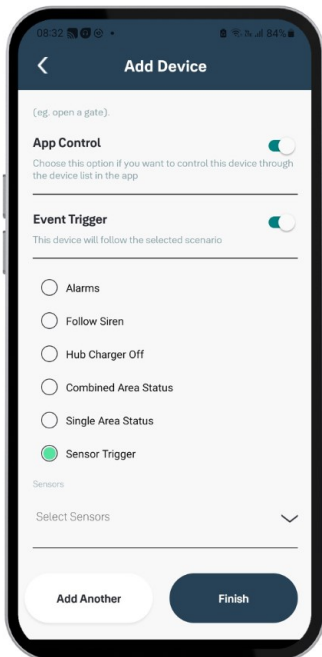

App Control : You can select to trigger the relay using the app.

Event Trigger: You can choose to select which event will trigger the relay

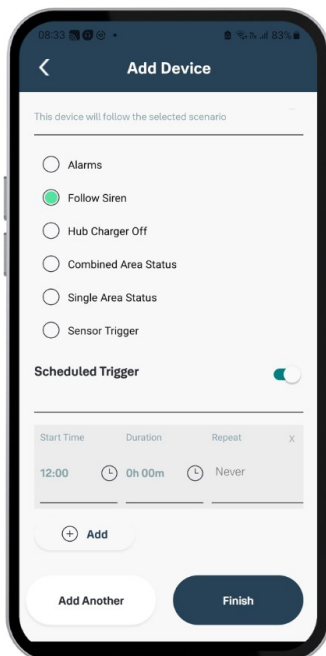

Scheduled Trigger: You can choose to schedule a trigger for a specific time and repeat it for specific days.

There is also an option to add multiple schedules

Wireless button

Once done, Click on Finish then your DC Relay channels will show on the device list

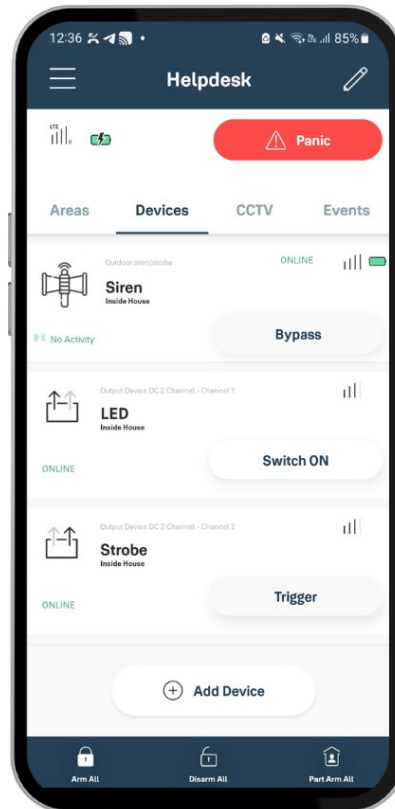

Technical Specifications

Power Input	12-24VDC
Standby Current	2.2mA at 13.8VDC
Max Current	59.5mA at 13.8VDC
Relay Rating	5A at 30VDC
RF Range	Up to 500m



Wireless button
